

# vismara

TECHNICAL  
SPECIFICATIONS

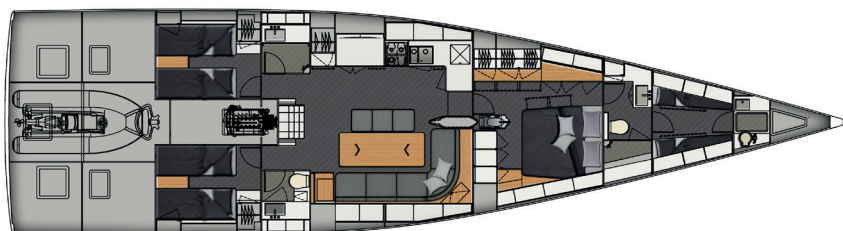

## VISMARA 68 MILLS

The new vismara's top-of-the-range cruiser-racer, designed in partnership with Mark Mills, basically the evolution of V62 Supernikka project, winner of no less than three mini maxi rolex world championship.

Entirely built in carbon fibre for more lightness and speed; with a funny and performing hull, and a distribution of deck volumes that ensures safety and maneuverability not only in sailing but also comfort in cruising. In short, also from an aesthetic point of view... a proper "Porsche" of the sea! Aggressive, sporty, elegant and comfortable at the same time. All the technical, plant engineering and aesthetic solutions resulted from Vismara's, the owners' and its team's experience, offshore sailing professionals and real seafarers.

Loa	20.7 m
Beam	5.26 m
Draft	2.90 - 4.20 m
Displacement	22.000 Kg

Let's start from high modulus carbon fibre mast and boom, a new type of rigging in elliptic carbon fibre rod, park avenue boom with rectangular trellis. A newly renovated retractable keel with a carbon fibre mast-step integrated into the hull and deck structures, that allows a draught from 2.90 m to 4.20 m and maximum stability for sailing performances. Cruiser racer deck plan with 7 winches, 8 mm teak structural decking, very advanced single rudder, entirely retractable maneuver with hydraulically adjustable transversal carts, electric trasto, flying shrouds, square mainsail, electrical subservience for all cruising maneuvers. Anchor built into the bowsprit (2.5 m long), a big longitudinal tender compartment of 3.80 m inside the hatch, demountable bow helix and retractable winch drum for the mooring ropes.

Sail Area	152 m <sup>2</sup>
Engine	160 Hp
Material	Carbon-fiber

VISMARA 68 MILLS

vismara





